

LANDFILL SITES
Delaware County, Indiana

1. ✓ CORNER OF RIVER ROAD AND CR 400W. - Southwest corner of intersection west to pole barn, approximately 3/8 mile and includes the White River bank, numerous house on this dump. *found in open Dump file*
2. CORNER OF MCGALLIARD ROAD AND MUNCIE BY-PASS - Southeast corner, approximately 30 acres. *found in Open Dump file*
3. COUNTRY CLUB ROAD NORTH OF SPRINGWATER PARK - Houses built on this dump, also. *Springwater Park is 1800 N. Country Club Rd. is C.C. Rd some as 300 E*
NEW?
4. BUTTERFIELD ROAD/CORRIGATED CONTAINER CORPORATION - Entire parking lot is on top of a dump. *301 S. Butterfield* *Yes*
5. *Ford* WHEELING PIKE NORTH OF GASTON ROAD - Located on east side of Wheeling. *found in open dump file*
6. *Sawyer* SOUTH WALNUT STREET - Located north of *240?* Coulter Boiler Works *NEW?*
and south of Wilson Middle School.
Coulter B.W. found in 1971 City Directory: 2407 S. Walnut
7. *Melrose* METRO LANDFILL/EAST END OF MCGALLIARD ROAD on CERCLIS as Metropolitan San. Ldfl.
8. WESTSIDE PARK - Located on White River Boulevard between Batavia and Tillotson, entire park is on a dump. *NEW?*
9. NORTH BROADWAY BETWEEN UNION CHAPEL CHURCH AND GMC TRUCK - on CERCLIS as Feeney's Farm
10. 850 NORTH, NORTHEAST OF ALBANY - On south side of road, mobile home is located on top of dump.
found probable same in open dump file
11. ALBANY DUMP, EAST OF ALBANY - Turn south at first crossroad, located near the river. *NEW?*
12. FIELD HOUSE TO CENTRAL HIGH SCHOOL ALONG WHITE RIVER - Located on North Walnut Street close to downtown. *NEW?*
Current Telephone Directory: Central H.S. 801 N. Walnut
13. COUNTRY CLUB ROAD AND 12TH STREET - Dump is located across from Model Airplane field. *NEW?*
14. EATON TOWN DUMP - Known as Strawtown located just south of Eaton. *NEW?*
15. ✓ FUDD'S LAKE/OFF MUNCIE BY-PASS - Lake is surrounded by a dump, it is popular fishing area. *"Dump" SR 67 E 35.*
on CERCLIS as Eaton Rd Landfill & Lennington Area Dump.
16. SOUTH GHARKEY STREET NORTH OF HARTLEY TRUCK PARTS - Located on the east side of the road, known as a transfer station for Muncie Salvage. *NEW?*

Hartley Truck Parts 600 W. 23rd
1971 City Dir: Muncie Salvage Co., Ronald Teal, Pres; 2522 Gharkey St.
1978-84: SCA of Muncie at 2522 S. Gharkey St.

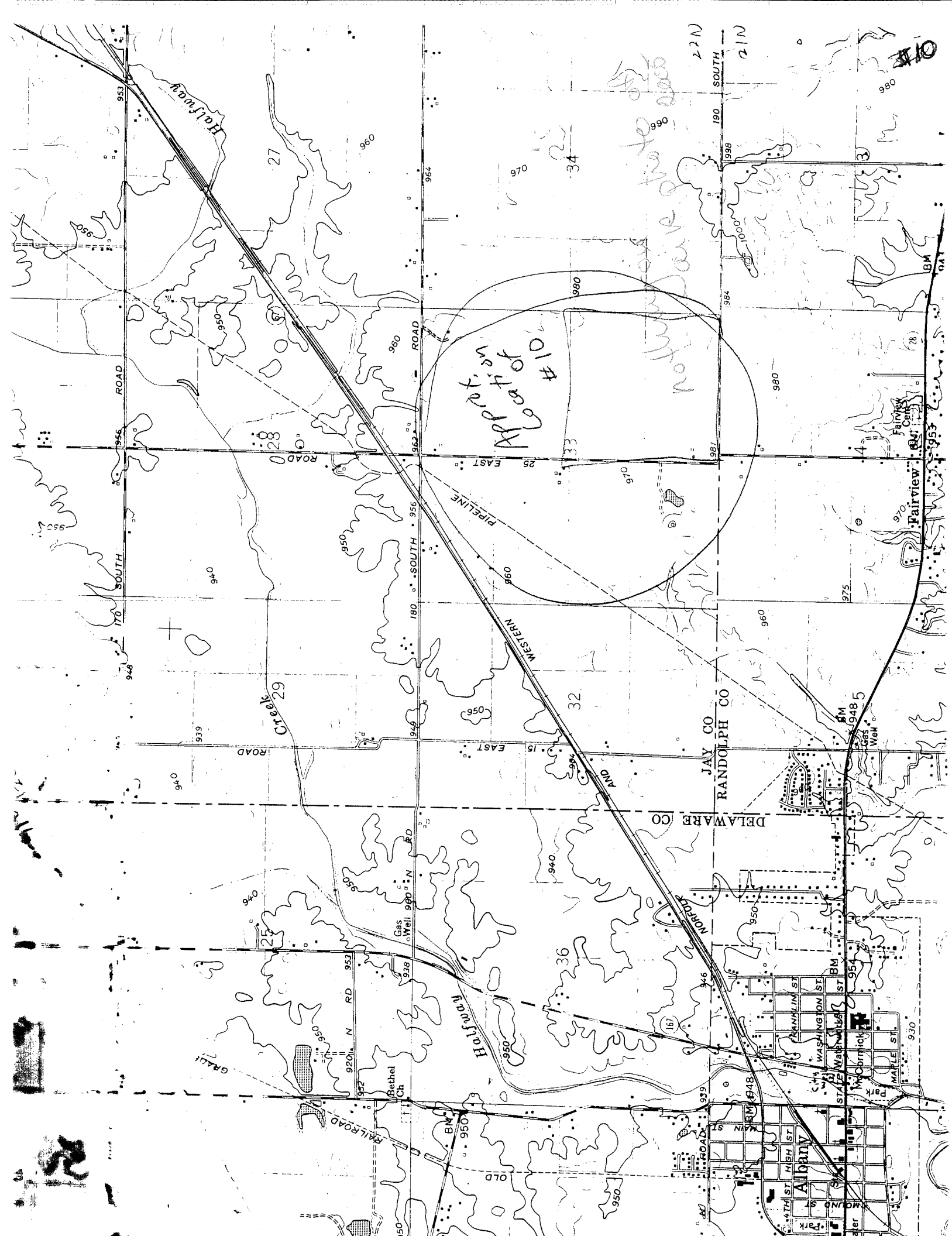

#11

#11

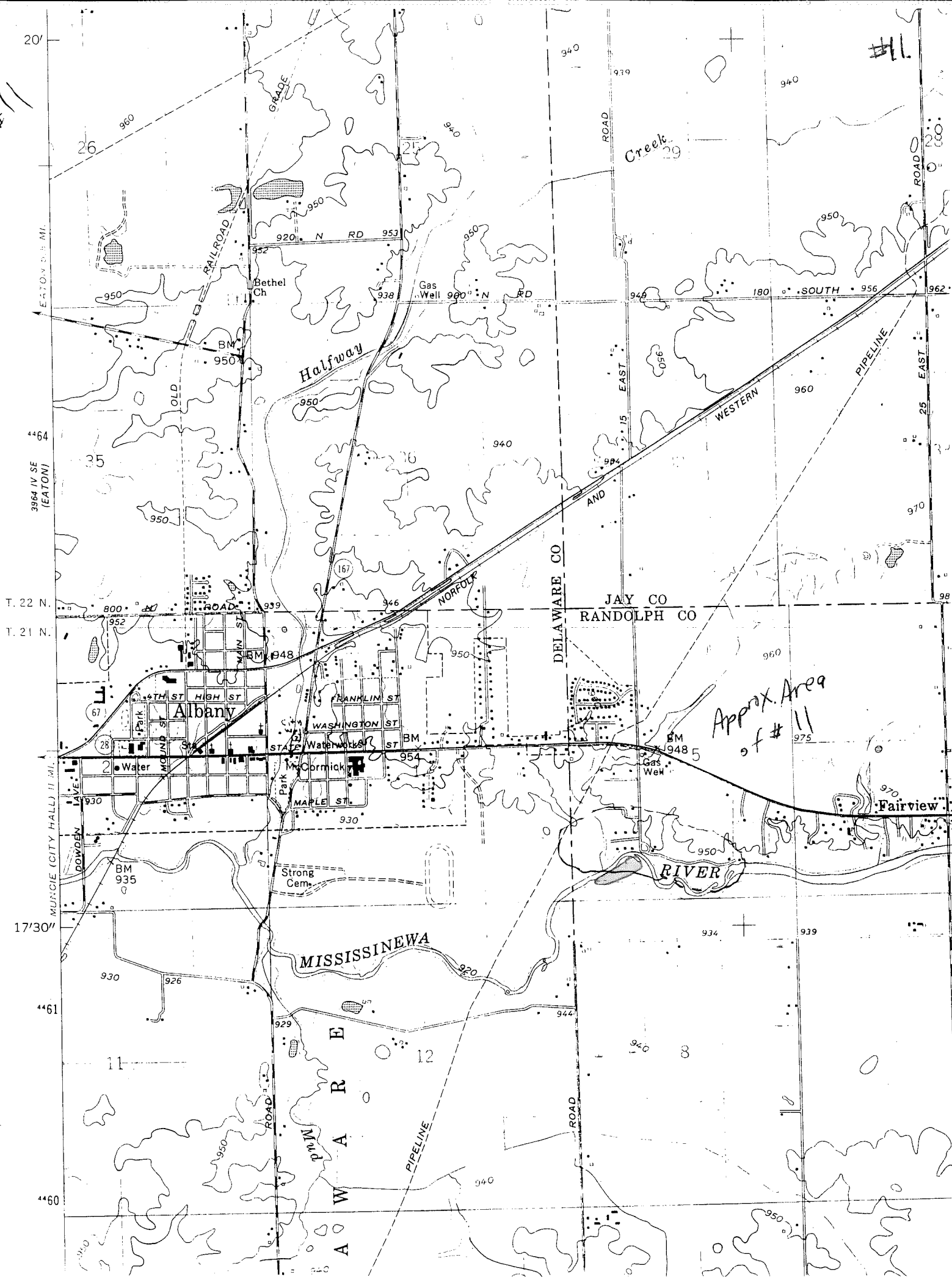

Approx. Area
of #11

Creek 29

MISSISSINEWA

Halfway

Albany

Fairview

JAY CO
RANDOLPH CO

DELAWARE CO

12

8

11

R
A
W
A
R
E

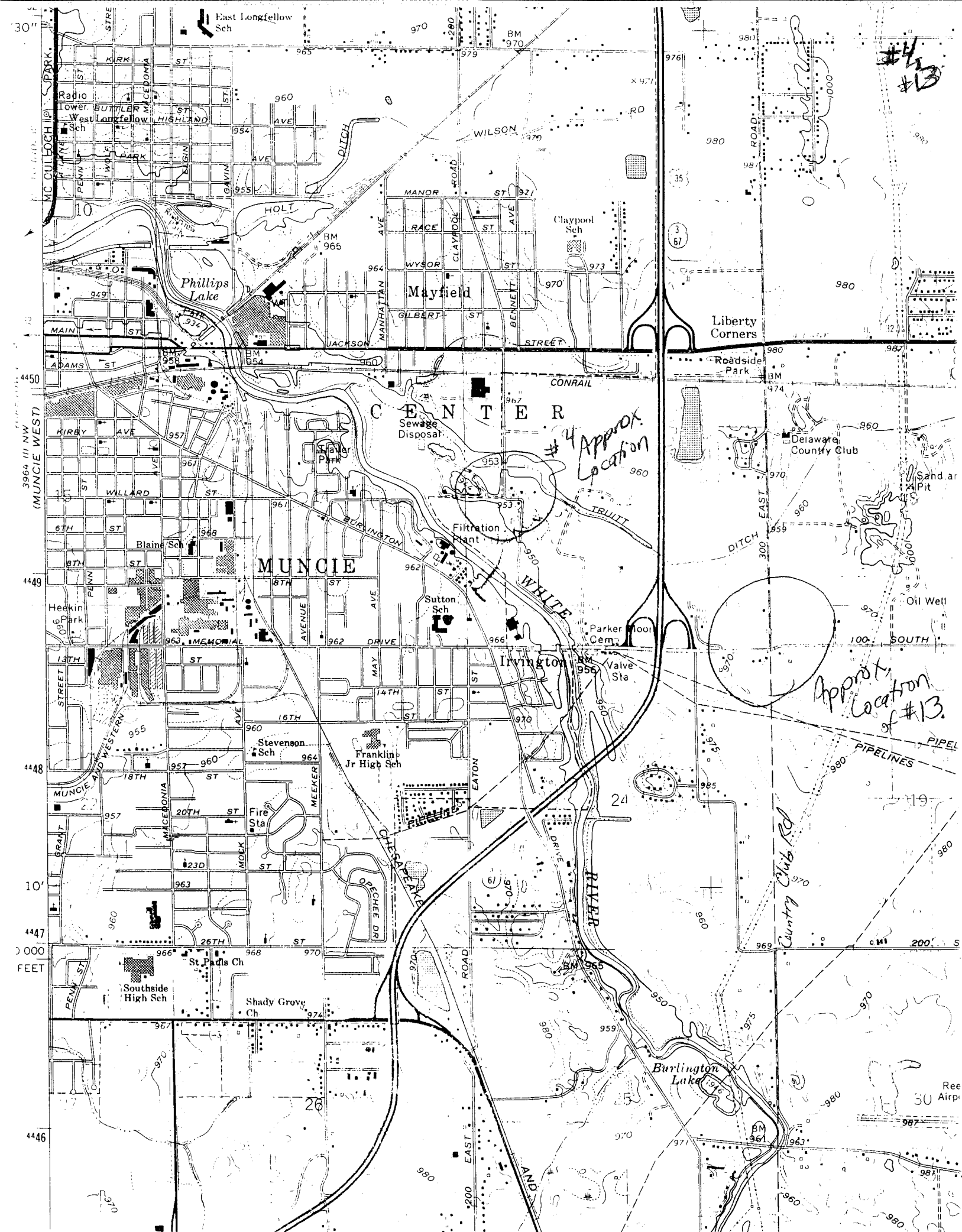

GEOLOGICAL SURVEY

85°22'30"
40°22'30"

HARTFORD CITY (JUNC. IND. 2° & 26) 5.3 MI.

40°00'00"E

41 R. 10 E. 20'

R. 11 E. #14

#14

Randy?

#14

4469

4468

4466

4465

WHEELING 5.1 MI.

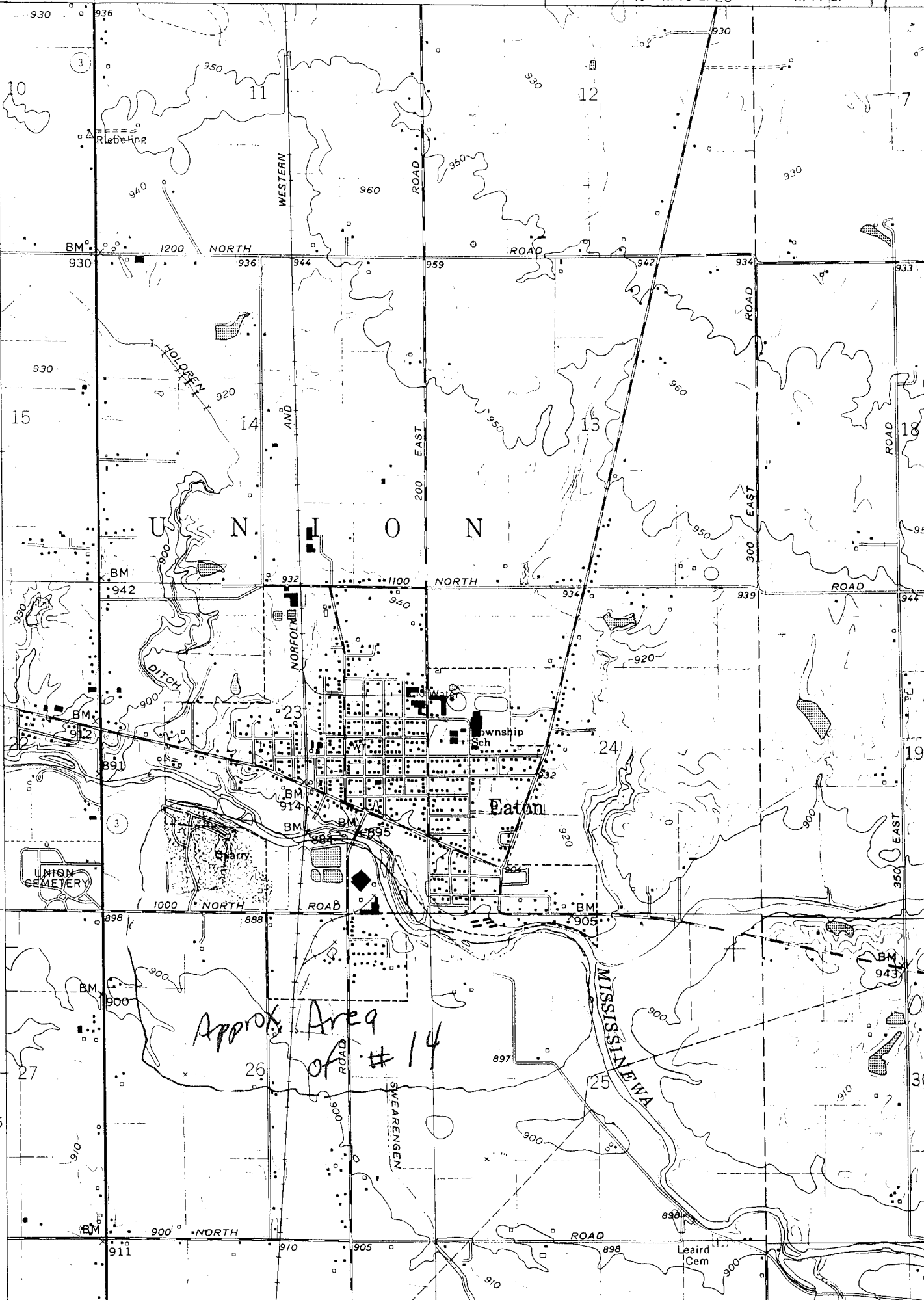

#2, 3, 9

#2, #3
Approx.
#9
Feeney⁴⁴⁵⁶⁰
(Farm)

